

## AUM 17 - automatic sensor-controlled tap with mixing valve



AUM 17 is an automatic sensor-controlled tap with mixing valve. Water turns on automatically when hands are within the sensor's range and keeps on running for a short period of time after the hands have been removed from the scanning zone ? after-flow delay time. The water stops flowing automatically if the sensor has been screened for longer than 30 seconds. The water temperature can be easily set by turning the upper ring on the tap. Automatic sensor-controlled taps AUM 17 meet EU standards and are intended for facilities where the user's comfort and the maintenance of hygiene is required at maximum water savings.

Rating: Not Rated Yet

[Ask a question about this product](#)

Manufacturer: [AZP Brno](#)

Description AUM 17 is an automatic sensor-controlled tap with mixing valve. Water turns on automatically when hands are within the sensor's range and keeps on running for a short period of time after the hands have been removed from the scanning zone ? after-flow delay time. The water stops flowing automatically if the sensor has been screened for longer than 30 seconds. The water temperature can be easily set by turning the upper ring on the tap. Automatic sensor-controlled taps AUM 17 meet EU standards and are intended for facilities where the user's comfort and the maintenance of hygiene is required at maximum water savings.

Complete delivery

1. faucet with mixing valve
2. electronics with a holder for hanging
3. electromagnetic valve (AUM 17, 17.B - 2 pcs.)
4. corner valve with filter (AUM 17, 17.B - 2 pcs.)
5. mixing T ? part with a cap nut (AUM 17.E)
6. battery holder (AUM 17.B)
7. cylindrical batteries 1,5 V (AUM 17.B) - 4 pcs
8. connecting hoses
9. fixing strap
10. M8 screw with nut and pads ? 2 pcs
11. tube with mastic

Requirements for setting up the construction

1. Set-up water inlet, pipe 1/2" ? as per picture
2. Set-up outlet ? as per siphon
3. Set-up cable for power supply ? 12 V, 50 Hz from source of power supply ZAC (does not apply to AUM 17.B)
4. Ceramics of the washbasin assembled as per picture

Download information about the product

- [AUM 17 data for projectants - \( 34 kB \)](#)

Basic technical information	Radius of sensor	automatically adjusted (other radius with remote ctrl.DO)
	Water inlet	G 1/2?
	Water pressure	0,2 ? 0,8 MPa (AUM 17.B)
		AA batteries ? 1,5 V (AUM 17.B) ? 4 pcs.
	Diameter of installation opening in washbasin	0 ? 4 sec. (adjusted to 1 sec.)
	Power supply	12 V, 50 Hz (AUM 17, AUM 17.E)
	Power requirement	ZAC 1/20 (max. 2 x AUM 17)
	Operating life of batteries	approx. 1,5 year at 100 operations a day
	Weight	2,7 kg

Figures

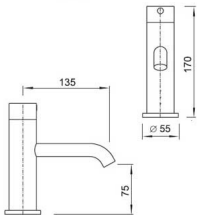

Reviews

There are yet no reviews for this product.